

## Freerider™

Cordless Robotic Cleaner

FR500 iQ

FR800 iQ

TYPE EA35--

### Before You Start

This Quick Start Guide contains essential installation and startup instructions. For additional operation, maintenance, and troubleshooting instructions, please refer to the complete Owner's Manual. Read the complete manual and all safety warnings before commencing installation.

This appliance is not intended for use by persons (including children) with reduced physical, sensory or mental capabilities, or lack of experience and knowledge, unless they have been given supervision or instruction concerning use of the appliance by a person responsible for their safety. Children should be supervised to ensure that they do not play with the appliance.

Do not expose the robot to an ambient temperature below 0°C and above 50°C. Only use the charger supplied. If the supply cord is damaged, it must be replaced by the manufacturer, its service agent or similarly qualified persons in order to avoid a hazard.

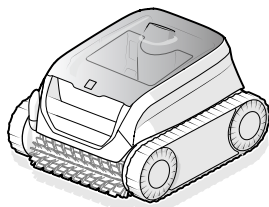

## Information/Status LEDs

### FR500 iQ

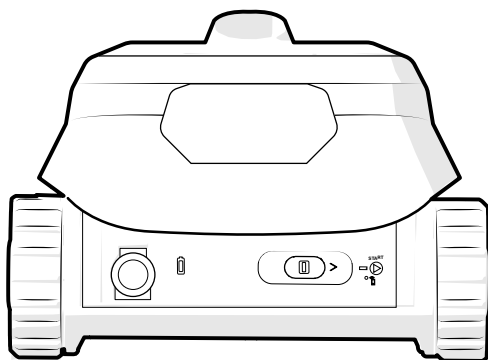

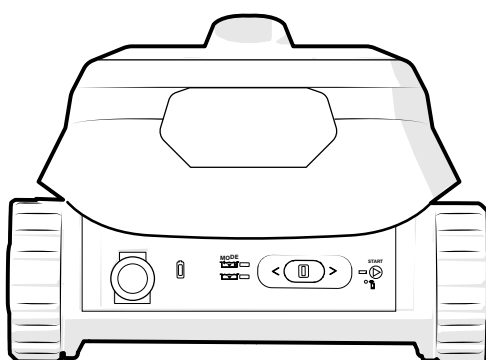

### FR800 iQ



#### Battery Status

- Solid Green Fully Charged.
- Blinking Green Ready to run full cycle (2h).
- Solid Orange Not fully charged. May not run a complete cycle.
- Blinking Orange Very low battery level. Change needed. Cannot run cleaner.
- Blinking Red Charging error. Cleaner is too hot.

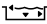
#### Cleaning Mode

- Floor and walls (2h) 
- Floor only (1h 30) (FR800 iQ model only) 

#### Wi-Fi Connection Status

- Blinking Blue Pairing.
- Solid Blue Connected to Wi-Fi

#### Operating Status

- Blinking Blue Out of Water: Ready to submerge, start cleaning.  
In Water: End of Cycle. Waiting for removal from pool.
- Blinking Red Error

#### Charging Status

- Solid Green Receiving power
- Solid Red Charging in progress

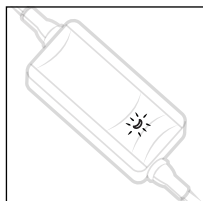

# 1. Setup and Charging

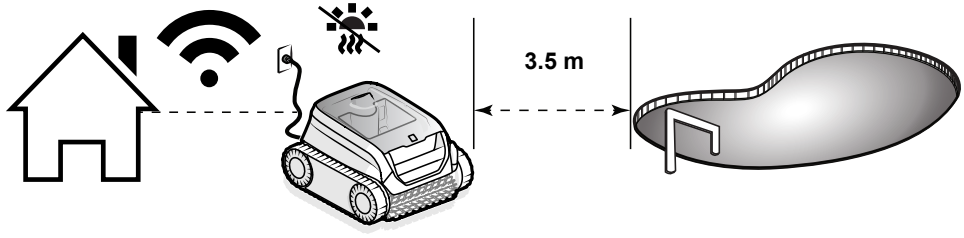

 **WARNING: Do not use extension cord.**

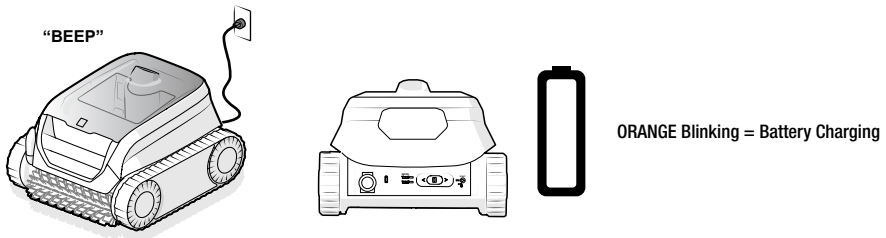

Select a charging location (RCBO outlet) at least 3.5 m away from the pool, out of direct sunlight and with adequate WiFi strength. **DO NOT** use extension cord.



## Start Cleaning

  Check current charge level in the App whenever the cleaner is plugged in for charging.

1. Fully charge the cleaner before the first cleaning.

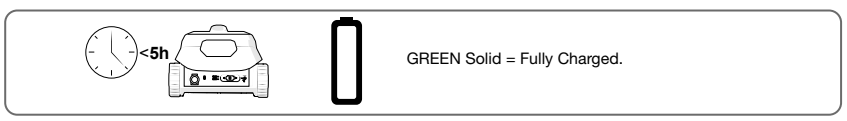

2. Select Cleaning Mode using the slider or the App.

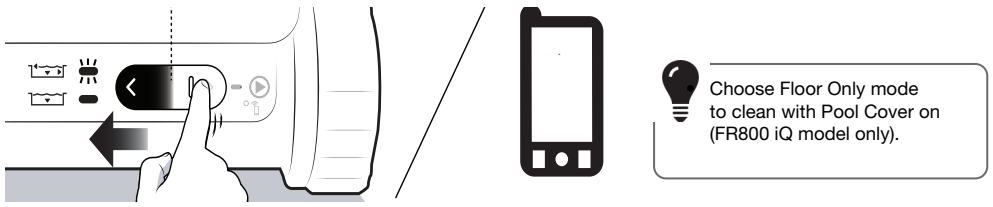

Slide + Release



3. Start the cleaner. Use the slider or the App.

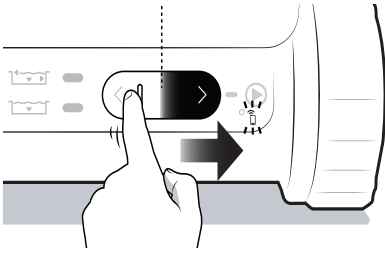

Slide + Release



Blinking Blue = Ready to Clean.  
Cleaner does not begin moving until it senses water. If water is not detected after 15 seconds, slide and release the slider and press Start again.

4. Submerge the Cleaner.

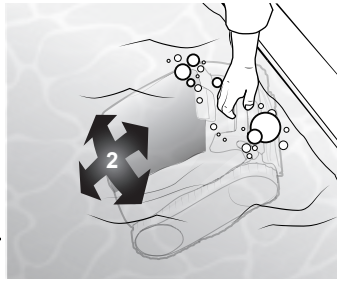
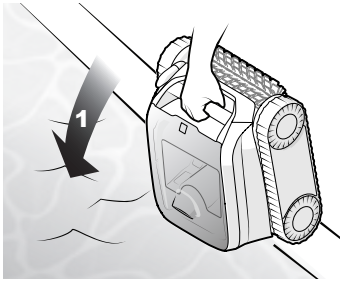

Wait for bubbles to stop completely, then let the cleaner sink to the bottom of the pool.

Cleaning cycle will start as soon as the cleaner detects the pool floor.

## 2. Remove from Pool - Cleaner Waiting



Cleaner waits at the waterline.



Cleaner waits at the bottom (retrieve with hook and pole).

- During the last 10 minutes of a cycle, (other than Floor Only), the cleaner climbs and waits at the waterline.
- If the cleaner is not retrieved after 30 seconds, it moves to a different wall. If not retrieved after 10 minutes, the cleaner returns to the pool floor for retrieval with the hook and pole.

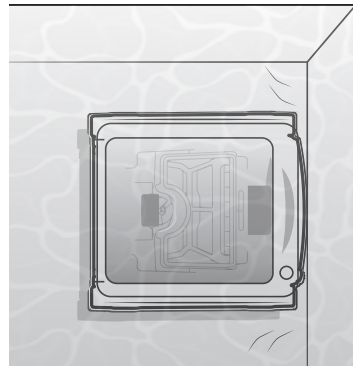

### Remove with hook

1. Attach the hook (comes in the box) to a standard pool cleaning pole (not included).



2. Secure the hook on the cleaner handle. Bring the cleaner to the waterline.

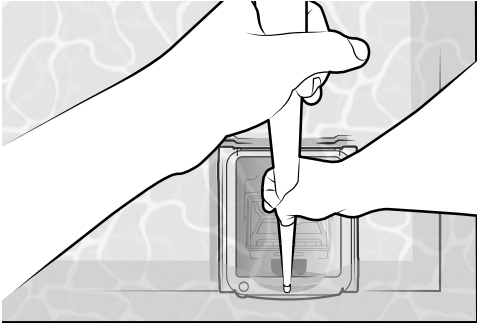

### Remove with Tap & Lift™

1. After the cycle is complete, tap cleaner lid once (x1). The cleaner will drive up the wall it is facing.

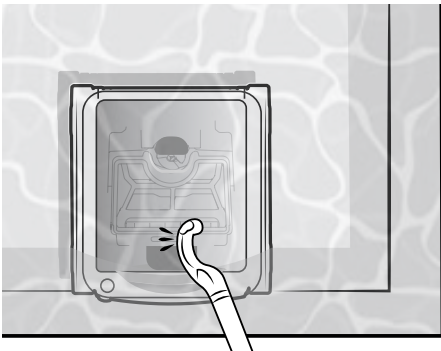

### Rinse and Store Cleaner

1. Hold the cleaner by the handle. Let the water drain.

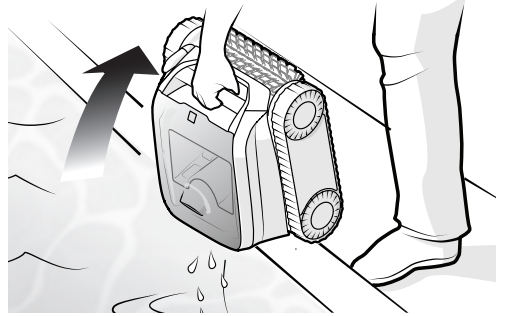

2. Remove the filter canister and rinse.

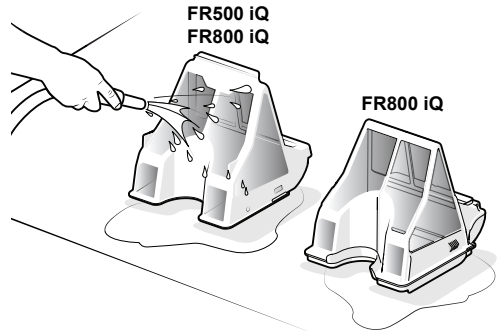
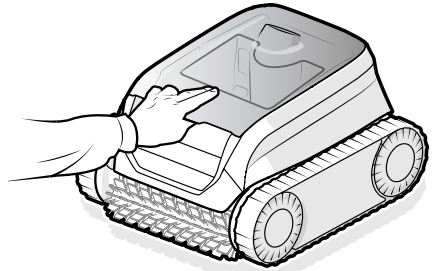

3. Store the cleaner out of direct sunlight.

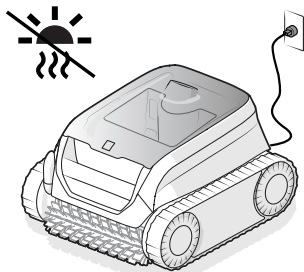

For best results, dry the cleaner charging contact before charging. Periodically clean the charging contact using a cloth or scouring pad and fresh water.



After 8 days of inactivity, the cleaner will enter Deep Sleep mode with all LEDs off. Re-set the cleaner on charger to wake up.

### 3. Install the App and Add your Cleaner



WiFi signals cannot travel underwater. Most app functions are therefore not available during a cleaning cycle. Place the cleaner back on the charging stand to reconnect to WiFi.

Before you begin installing iAquaLink®, make sure you have the following:

- Charger cord connected and plugged into a RCBO outlet.
- Robotic Cleaner plugged into charger.
- Wi-Fi and Bluetooth enabled smart device (phone or tablet).
- Wi-Fi router with sufficient signal strength at the Charger.
- IMPORTANT: Have your Wi-Fi network password available.



1. Download iAquaLink app from the App Store or Google Play.
2. Open the iAquaLink app, then Sign Up or Log In.
3. Follow the on-screen prompts to add your cleaner.
4. Slide the slider right and HOLD for ten seconds to put the cleaner in Pairing Mode. Wi-Fi LED indicates connection status.

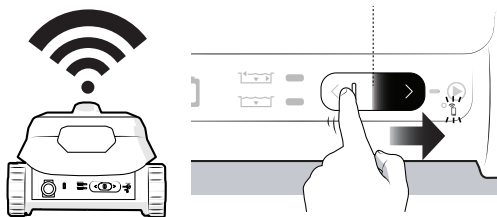

Slide and HOLD for 10 seconds



Blinking Blue - Pairing

Solid Blue - Connected to Wi-Fi



If you have problems connecting, the Wi-Fi signal may not be strong enough next to the pool. Try placing the cleaner in another location closer to your home router.



<p style="text-align: center;">WARRANTY REGISTRATION</p>	<p>Record your equipment details here for quick reference:</p> <p>Model No.: _____</p> <p>Serial No.: _____</p>
	<p>AUSTRALIA WARRANTY:</p> <p>For full warranty terms and conditions and to register your warranty, visit <a href="http://www.zodiac.com.au/warranty">www.zodiac.com.au/warranty</a> and complete your details.</p> <p>◀ Or scan the QR code to go directly to the registration page.</p>
	<p>NEW ZEALAND WARRANTY:</p> <p>For full warranty terms and conditions and to register your warranty, visit <a href="http://www.zodiac.co.nz/warranty">www.zodiac.co.nz/warranty</a> and complete your details.</p> <p>◀ Or scan the QR code to go directly to the registration page.</p>

**Fluidra Group Australia Pty Ltd**

1 Herbert Place, Smithfield NSW 2164  
 PO Box 7238 Wetherill Park NSW 1851, Australia  
 ABN: 87 002 641 965  
 Zodiac.com.au | 1300 186 875

**Fluidra NZ Ltd**

13 Douglas Alexander Parade  
 Rosedale Auckland 0632, New Zealand  
 NZBN: 942 903 181 70759  
 Zodiac.co.nz | 0800 807 665

©2025 Fluidra. All rights reserved. The trademarks and trade names used herein are the property of their respective owners.